

Two Rivers Watershed District Klondike Clean Water Retention Project #11 - Fact Sheet - 10/1/22



Outlet SD 95 (Southwest Outlet)

The proposed gated structure is adjacent to SD 95 Lat 1, located 2.5 miles west of the Roseau Kittson County line.

Design of the impoundment outlets references TR-60 for sizing the gates, conduits, drop inlets, and emergency spillways. HEC-HMS and EPA-SWMM were primarily used to complete these calculations and test the sensitivity of each component. Additional detail on the outlet structure is included in the Operating Plan.

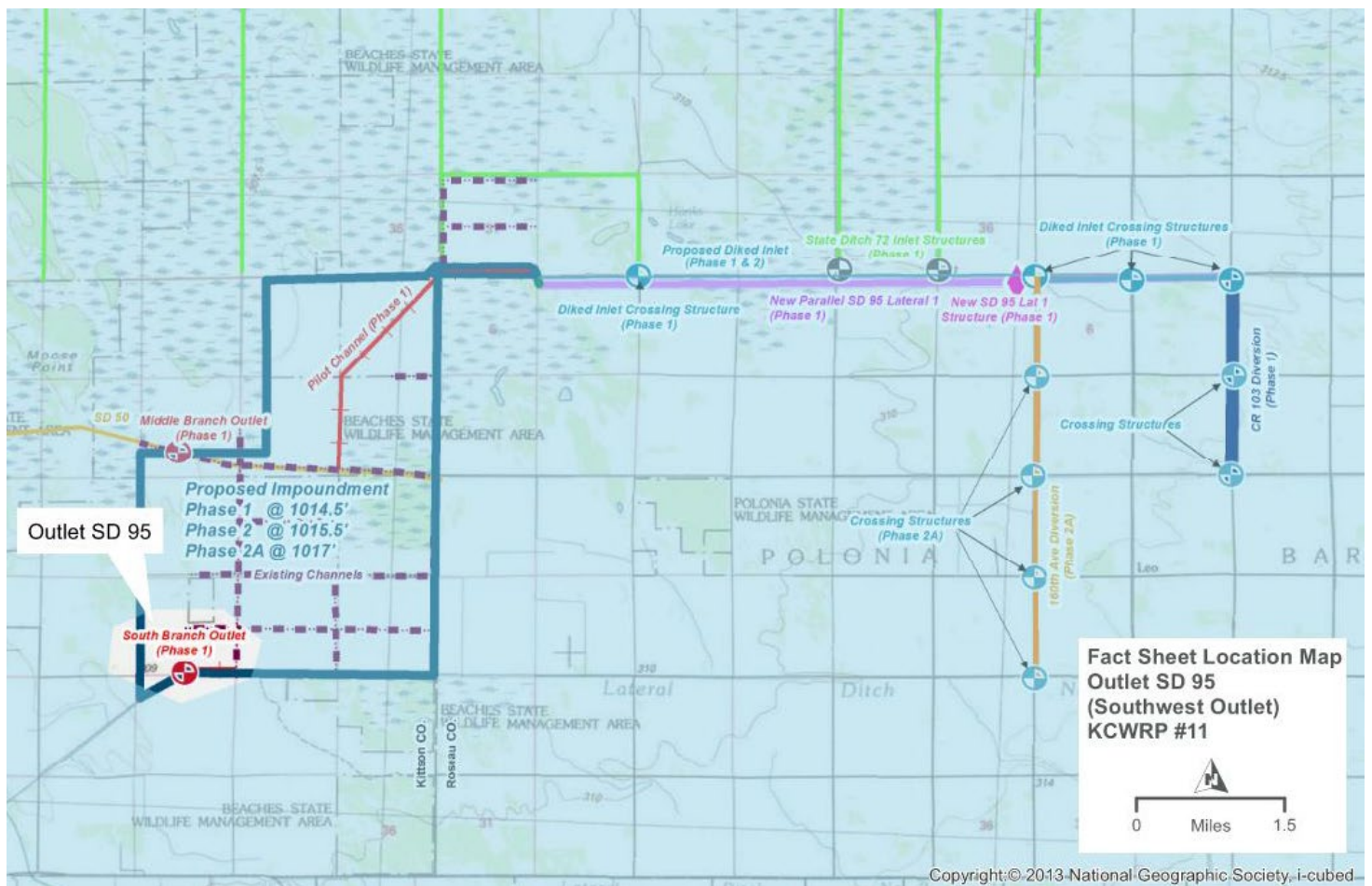

Structure	Gate Size [WxH]	Culvert Size	Concrete Riser Size	Top of Concrete	Gate opening Invert
SW Outlet	(1) - 6' x 6'	(1) - 6' x 6' RC Box	12' x 28'	1015.5'	1006.1'



Roseau County in foreground; Lat1 Br4 SD95 - Kittson County in background; Lat1 SD95

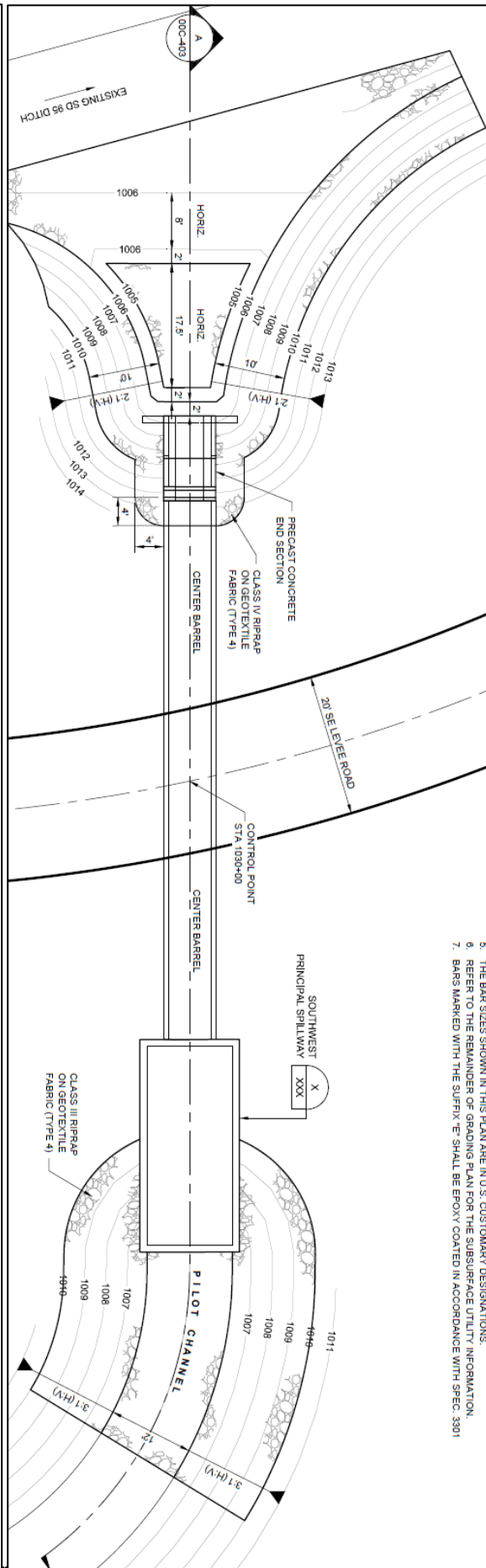

5. THE BAR SIZES SHOWN IN THIS PLAN ARE IN U.S. CUSTOMARY DESIGNATIONS.
6. REFER TO THE REMAINDER OF GRADING PLAN FOR THE SUBSURFACE UTILITY INFORMATION.
7. BARS MARKED WITH THE SUFFIX 'E' SHALL BE EPOXY COATED IN ACCORDANCE WITH SPEC. 3301

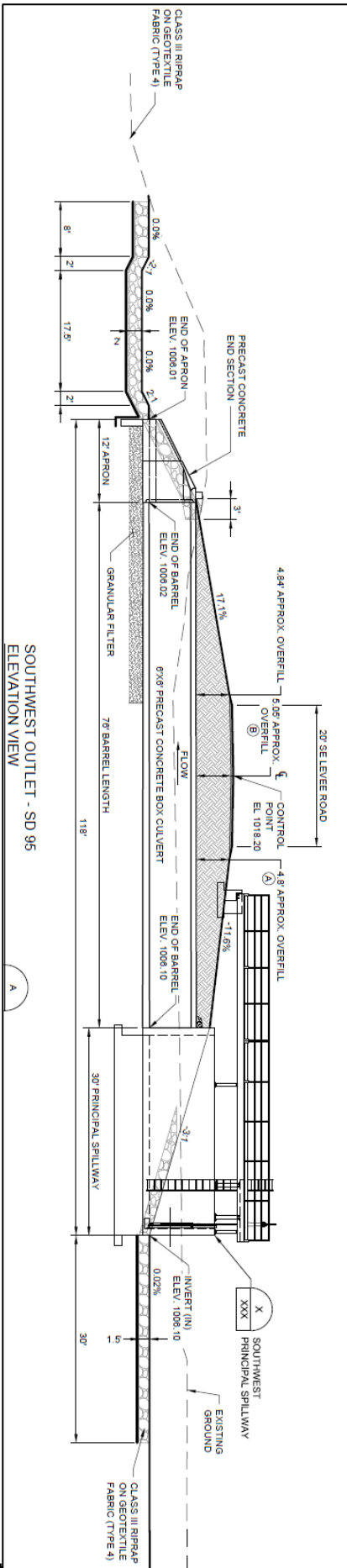

SOUTHWEST OUTLET - SD 95
ELEVATION VIEW